

Bolted HOLDER ASSEMBLY

The Bolted Holder Assembly is one of Oseco's most popular rupture disk holders.

The Bolted Assembly is available with any combination of either weld-neck or threaded inlet and outlet connections. Full diameter flat-faced inlet and outlet flanges are available and designed to be used between ANSI companion flanges. The Bolted Rupture Disk Holders are designed to be used with or in place of ANSI B16.5. Standard materials of construction are carbon steel and 316 Stainless Steel. Other materials are available on request.

Types of Bolted Assemblies: (Inlet / Outlet)

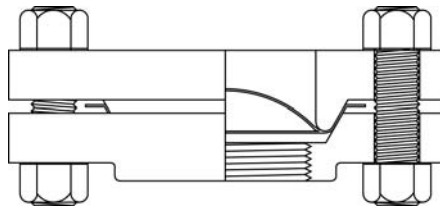

RDH-1 (Threaded Inlet / Flat Outlet).

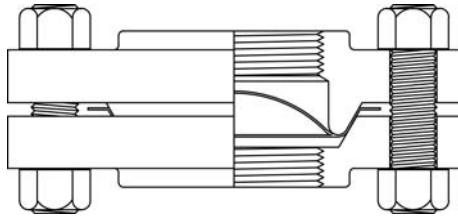

RDH-2 (Threaded Inlet / Threaded Outlet).

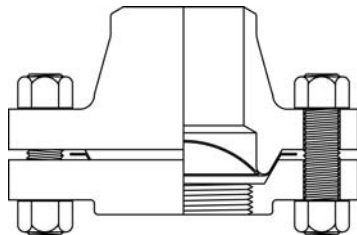

RDH-3 (Threaded Inlet / Welded Outlet).

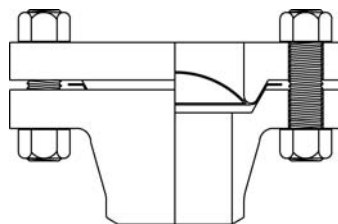

RDH-4 (Welded Inlet / Flat Outlet).

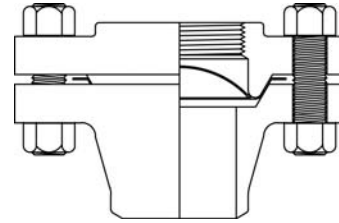

RDH-5 (Welded Inlet / Threaded Outlet).

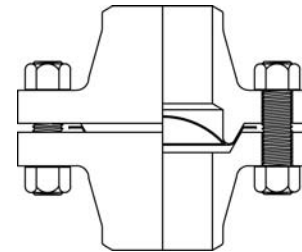

RDH-6 (Welded Inlet / Welded Outlet).

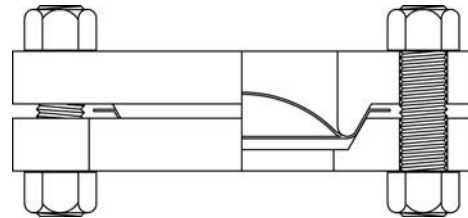

RDH-7 (Flat Inlet / Flat Outlet).

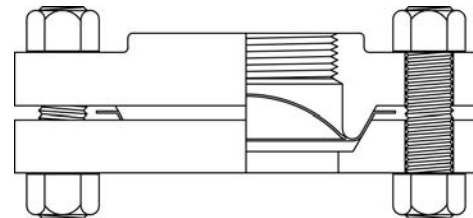

RDH-8 (Flat Inlet / Threaded Outlet).

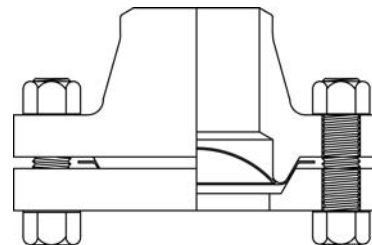

RDH-9 (Flat Inlet / Welded Outlet).